

NOTES:

- MANUFACTURED MATERIALS-
 - FEEDER FRAME, DRIVE HOUSINGS AND MISC. PARTS MANUFACTURED FROM ALUMINUM AND WITH A CLEAR ANODIZE COATING.
 - DRIVE SHAFTS, WEB GUARDS AND MISC. PARTS ARE MANUFACTURED FROM STAINLESS STEEL AND WITH A POLISHED FINISH
 - BRUSH CORES, VACUUM BLOCK, FEED TUBE AND PRODUCT FALLS MANUFACTURED FROM WHITE DELRIN
 - VISIBILITY PANELS ARE MANUFACTURED FROM CLEAR LEXAN SHEET
 - PRODUCT PADDLES ARE MANUFACTURED FROM TRANSLUCENT FDA SILICON RUBBER SHEET
 - GEARS AND BUSHINGS ARE MANUFACTURED FROM BRASS/BRONZE
- PURCHASED COMPONENTS-
 - BALDOR MOTORS #GPP233111 AND ALL BEARINGS ARE SEALED

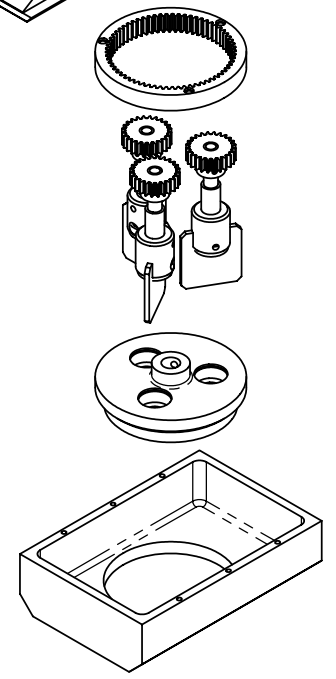
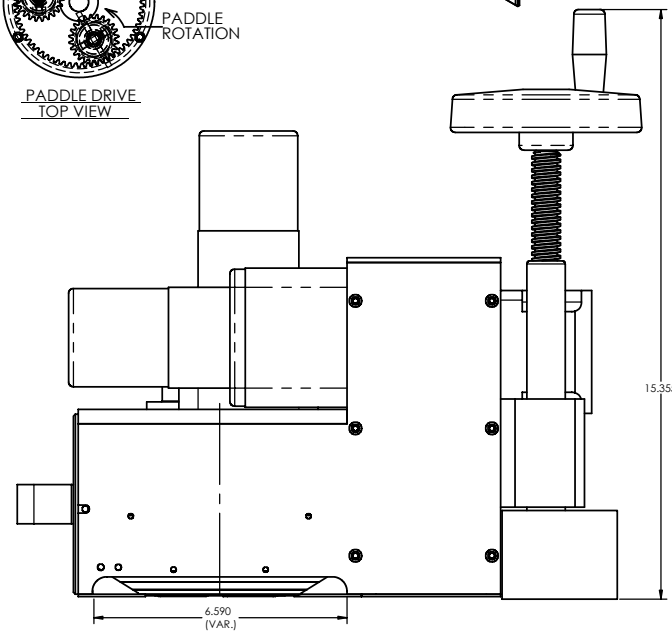
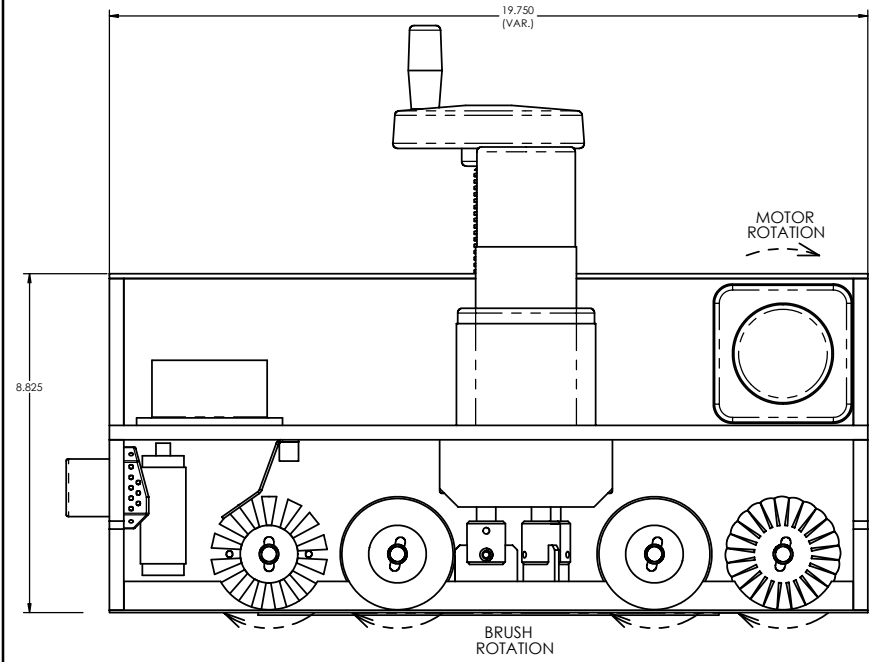
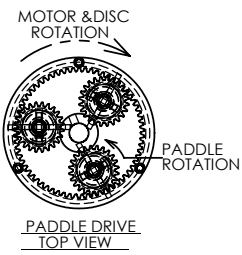
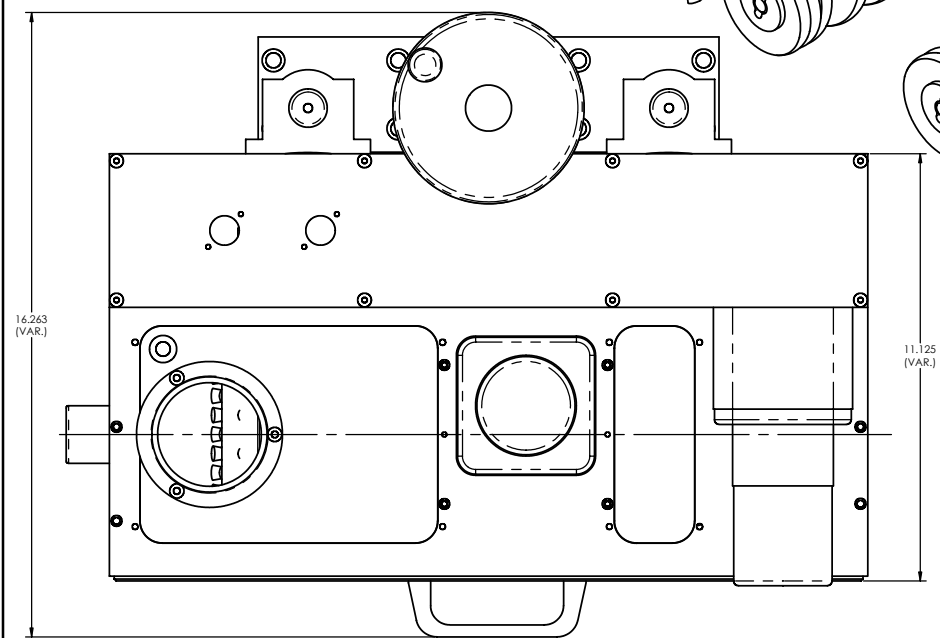
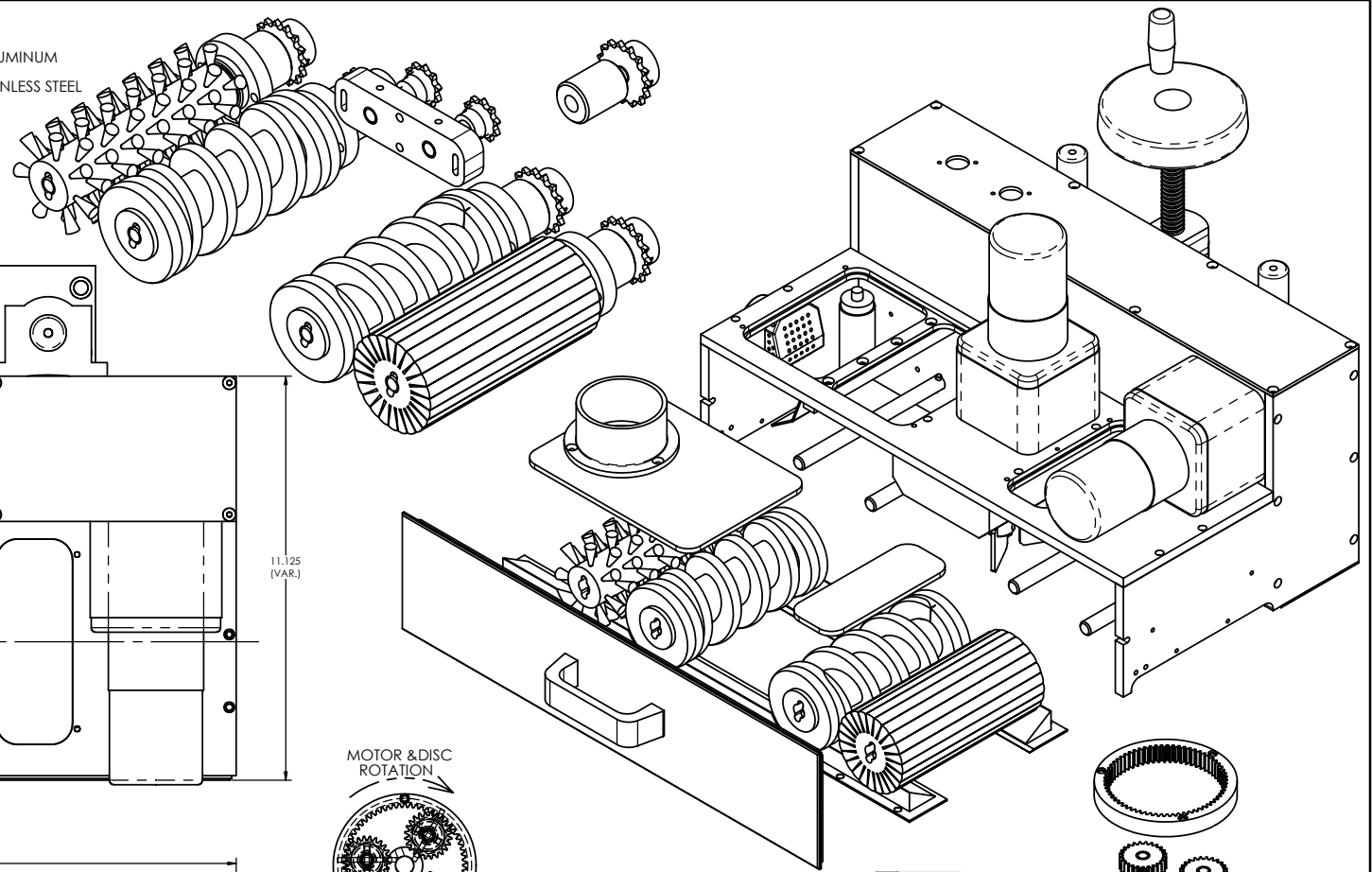

STANDARD TOLERANCES UNLESS OTHERWISE SPECIFIED			SCALE: N.T.S.	DWN BY: M. PARLAPIANO
DECIMAL	SIZE	FINISH	DATE: 10-27-03	APP BY: G. PERRELLI
.XX	±.01	125		
.XXX	±.004	32		
.XXXX	±.0003	16		
ANGULAR TOLERANCE:	±1/2		MACHINE: DUAL DRIVE FLOOD FEED	MODEL#: 20481PCFF2000
				SERIAL#: 168X462HV1027

COMPACT FLOOD FEED

DWG.#: E-20481P-CIT2003